

# CART-KING INTERNATIONAL

Get your sales rolling...

**Custom  
Graphic  
Kits!**

**Only  
\$3999  
USD**

## EZ Kiosk

- 1 EZ-Kiosk Modular System
- 2 Strong steel construction
- 3 Four adjustable shelves
- 4 Fridge or Freezer capable
- 5 Locking inventory storage
- 6 Retail Gridwall Included
- 7 Four Locking caster wheels
- 8 Easy pop off canopy
- 9 Menu Holders Included
- 10 Matching sink set available



Retail Kiosk



1-877-986-7771  
[www.cart-king.com](http://www.cart-king.com)  
[info@cart-king.com](mailto:info@cart-king.com)



1-877-986-7771  
www.cart-king.com  
info@cart-king.com

## Transform Your EZ-Kiosk With Your Own Colors and Branding

- Customize your EZ-Kiosk to your specifications.
- Decide your own graphical body wrap.
- Apply the brands, graphics and colors of your choice.

Info Kiosk



Coffee Kiosk



Food Kiosk

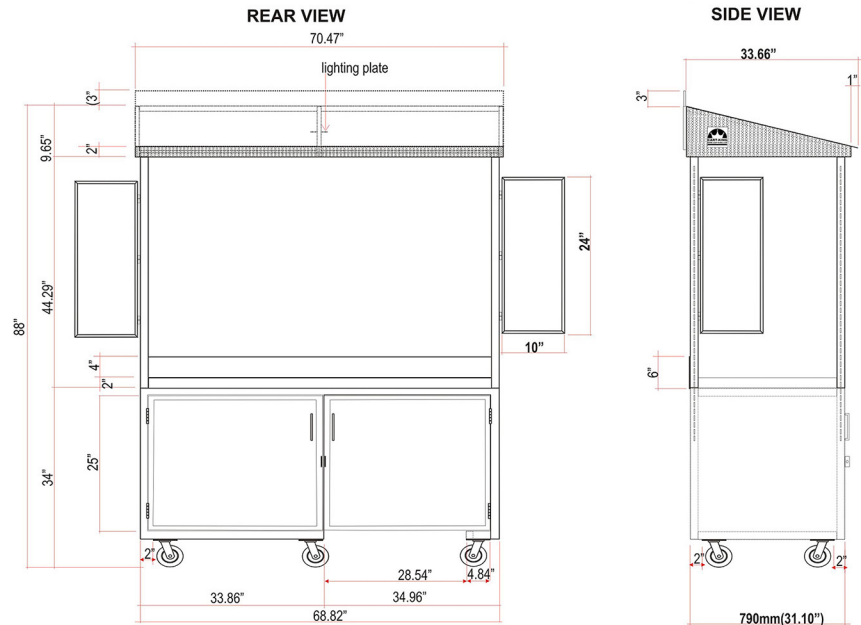

Removable Grid-Wall

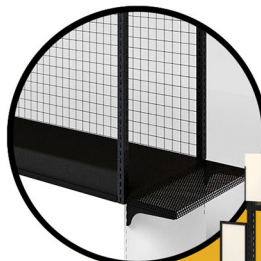

Pop Off Canopy For Doorways



Locking Casters



Hinged Menu Holders



Fits Commercial Fridges



Locking Steel Base



Removable shelf





1-877-986-7771  
www.cart-king.com  
info@cart-king.com

# UPGRADES

## Zip Down Cover 899



## LED Under Canopy Lights 299



## Custom Graphical Wraps 899



## Quad EZ Kiosk 16' x 10'



## Self Contained NSF Sinks 3999



### Features

- NSF Certified for hand-washing
- Contains two 5-gallon tanks for fresh water and two 7.5-gallon tanks for waste water
- Water Heater-Adjustable-13 Amp (Heats from 95 to 155 degrees Fahrenheit)
- Contains four safety-lock casters for easy Mobility
- Construction: Aluminum bar frame with solid plastic panels

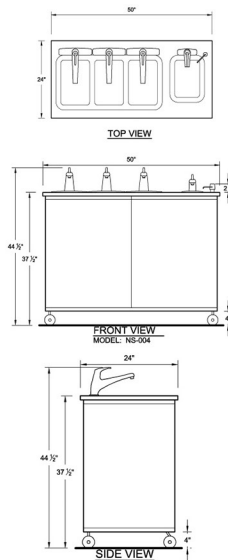

### Basin Measurements

	(3 Large)	(1 Small)
Width:	9"	7-3/4"
Length:	14"	11-5/8"
Depth:	10"	5"

This item has met the following  
Certifications & Approvals

Entire Unit is NSF Certified

CSA Water Pump

UL Water Heater



## EZ-Kiosk With Sink

